



RECYCLE
YOUR RAIN!



RainPerfect™

Solar Powered Rain Barrel Pump System



OWNER'S GUIDE

Step by step instructions for setting up your RainPerfect™ pump and solar panel



The RainPerfect™ pump and solar panel install easily and provide plenty of pressure to run water through a garden hose.

The pump provides enough pressure to run most low pressure sprinklers, wash a car or water just about anything around your home.

With the solar panel and rechargeable NiMH battery, there is no need for an electrical outlet making the RainPerfect™ pump ready to go anywhere anytime, day or night.

KIT CONTENTS

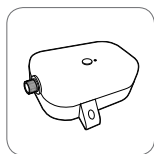

Battery & Control Box

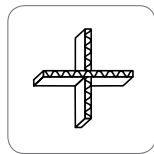

Cardboard X

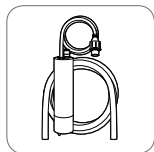

Pump with 40" (1 m) Hose

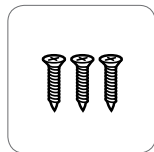

(3) Phillips Head Screws for Mounting Control Box



(2) Hose Clamps



(4) Phillips Head Screws for Mounting Solar Panel

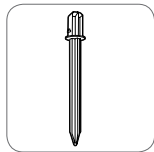

Solar Panel Ground Anchor



Solar Panel & Mounting Bracket with 15' (4.6 m) Power Cord

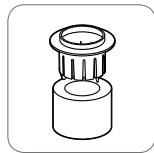

Strainer and Filter

Your RainPerfect™ pump has the capacity of pumping 100 gallons of water per charge with 13 psi of pressure! It has the ability to empty a 55 gallon rain barrel in approximately 18 minutes and will empty almost two barrels on a single charge...at no additional electrical cost to you.

With simple household tools, you should be up and running in no time.

When you are ready to begin, PLEASE see the battery connection instructions on the bottom of the control box for proper battery installation.

TOOLS YOU'LL NEED

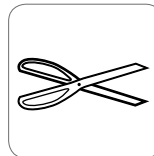

Scissors

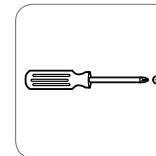

Phillips Head Screw Driver

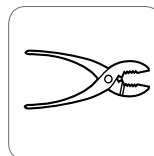

Pliers

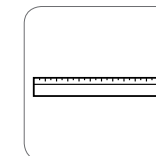

Ruler

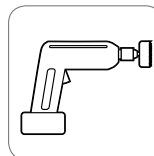

Hole Saw (Optional)

BATTERY INSTALLATION

Note: Battery is shipped disconnected and must be installed prior to use.

Please see the battery connection instructions on the bottom of the control box for proper battery installation.

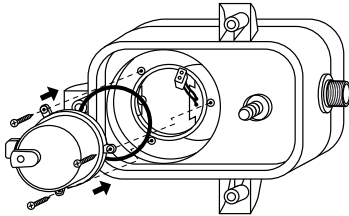

CABLE ATTACHMENT

Line up male and female connectors from the control box to the solar panel or pump, press firmly together and finger tighten sealing sleeve.

TO OPERATE THE PUMP

Hold down the yellow button for three seconds to turn the pump on and off. A green light will display while the pump is running.

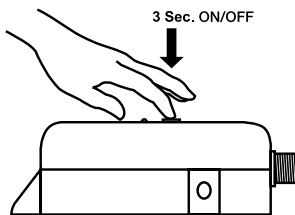

TO TEST THE BATTERY

Ensure the pump is powered off. Tap the yellow button once to determine how much charge is left in your battery.

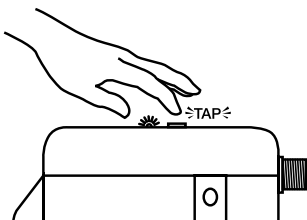

Green = Good (100% - 85%)
 Yellow = OK (85% - 80%)
 Red = Charge (80 - 75%)

If battery voltage is below 75%, the pump will not turn on.

HOLE DIMENSIONS

If your rain barrel does not have a hole cut out of the top, simply drill a minimum 2.25 inch hole and drop the pump into the barrel.

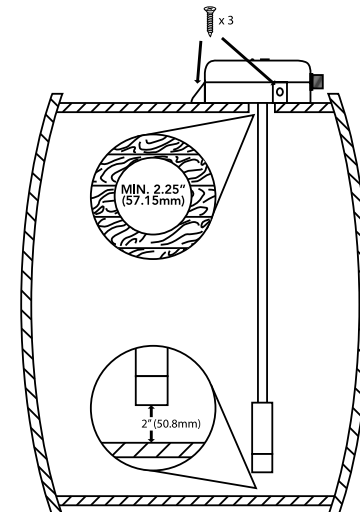

HOSE HEIGHT ADJUSTMENT & HOSE CLAMP ASSEMBLY

When inserted, the pump should remain approximately 2 inches above the bottom of the barrel.

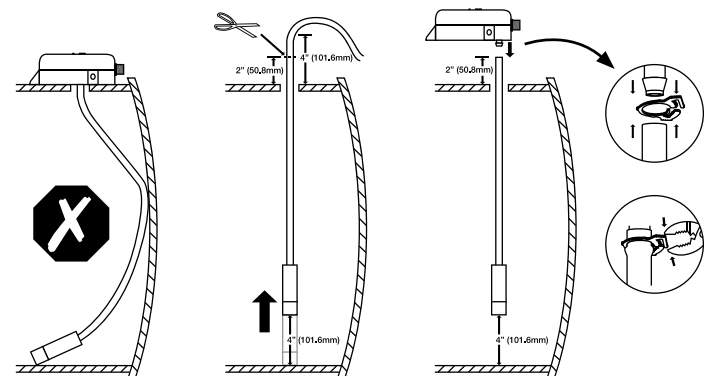

TO INSTALL ON A RAIN BARREL

Set up your solar panel in an ideal spot and allow the battery to fully charge before first use, approximately 8 hours of full sun. (See Proper Alignment for positioning)

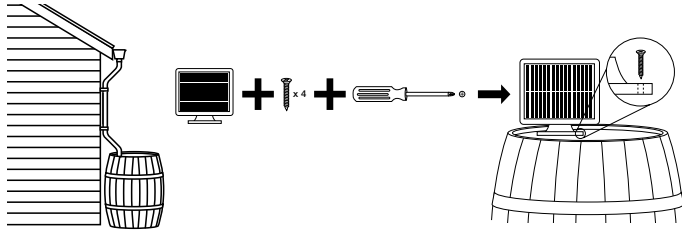

TO INSTALL WITH GROUND ANCHOR

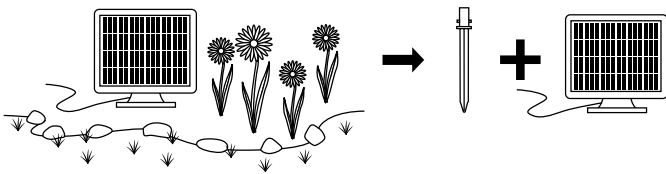

Press or gently tap the spike into the ground with the top arrow properly aligned for maximum sun exposure. (See Proper Alignment for positioning)

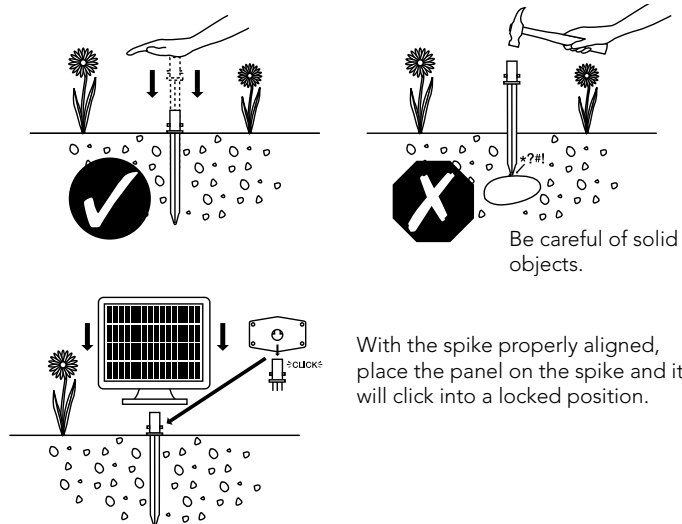

With the spike properly aligned, place the panel on the spike and it will click into a locked position.

SET THE ANGLE OF THE SOLAR PANEL

Aim panel directly at the sun. For best results, set it up at noon when sun is directly overhead. Pump will fully charge with 8 hours of sufficient sunlight.

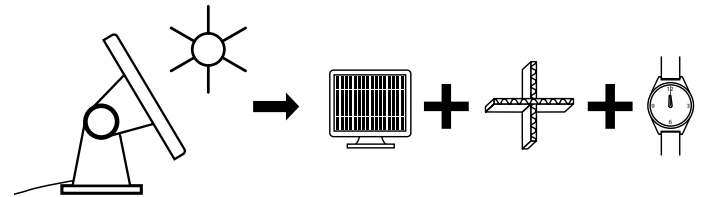

PROPER ALIGNMENT

The best way to determine the correct angle of the solar panel is when the sun is directly overhead at noon. Use the cardboard "x" in the kit to align the panel to the sun. Adjust the panel until there are no shadows remaining at noon time. Now the panel is properly set. Turn knob clockwise to secure panel in place.

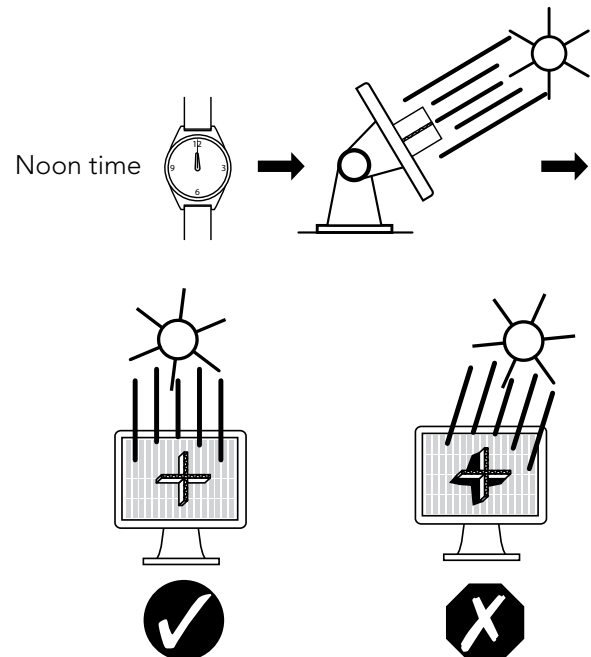

IF YOU NEED ANY REPLACEMENTS PARTS

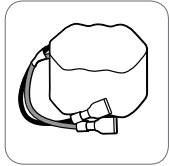

NiMH Rechargeable Battery **Part # R-1001**



Solar Panel & Mounting Bracket with 15' (4.6 m) Power Cord **Part # R-1002**

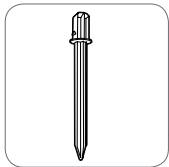

Solar Panel Ground Anchor **Part # R-1003**

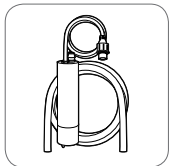

Pump with 40" (1 m) Hose **Part # R-1004**

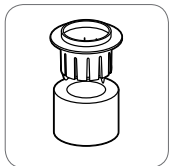

Pump Strainer and Filter **Part # R-1005**

Please visit www.rainperfectpump.com for a list of stores carrying our replacement parts and have the part number ready when ordering.

PUMP IS NOT PUMPING

- Check battery charge (see page 3 for details)
- Check wire connections
- Check that your rain barrel has water in it
- Check hose for any kinks
- Check that hose is firmly secured from pump to the control box
- Check pump filter for debris such as leaves and twigs



Periodic cleaning of pump filter will prevent debris build up & allow maximum flow.

BATTERY NOT CHARGING

- Check alignment of solar panel (see page 6 for details)
- Check wire connections from control box to solar panel
- Check solar panel wire for any cuts or damage
- The battery may not charge during long durations of cloudiness

WARNING: Do not attempt to charge the battery in an enclosed area. Charge in a well ventilated area to prevent incineration.

SAFETY PRECAUTIONS

Always keep your rain barrels covered, keeping children and pets from falling in — and keep mosquitoes and larvae from reproducing, by covering all open holes.

Only use rain barrel water for your lawn or garden, NEVER for drinking.

ADDITIONAL INFORMATION

Note: Some water will drip from the hose elbow during normal operation.

Please review the following precautions before using your RainPerfect™ pump.



12v NiMH Battery & Pump

12v NiMH Battery



WARNING: Exposure to damaged or ruptured batteries is a health hazard and should be avoided. If any liquid from the NiMH battery comes in contact with your skin, quickly wash with mild detergent and water, neutralize liquid with a mild acid such as vinegar and consult a doctor if necessary. If the liquid should enter your eyes, flush with clean water for fifteen minutes and consult a doctor for further instructions.

Contact your local recycling center for information regarding proper disposal methods.

Do not incinerate the NiMH battery pack as it has the potential to explode under high heat causing severe injury and may create toxic fumes.

Store your pump indoors during times when temperature drops below freezing on a regular basis. Remember to disconnect battery during long periods of storage.

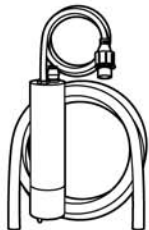

H₂O ONLY

This pump is designed for use with fresh and salt water only. DANGER: Use with any hazardous, caustic, corrosive, or flammable liquids/vapors could result in damage to the product and the surrounding environment; including but not limited to, exposure to hazardous substances and personal injury.

ONE YEAR LIMITED WARRANTY

All products of the company are sold and all services of the company are offered subject to the company's warranty terms and conditions of sale, copies of which will be furnished upon request. The information provided herein is for guidance only, it does not constitute a guarantee of the performance or specification of any individual product or component.

To request a copy of the limited warranty, please contact:

RainPerfect™ Warranty Information
 Xylem Flow Control
 Cape Ann Industrial Park
 Gloucester, MA 01930
www.rainperfectpump.com



Cape Ann Industrial Park Gloucester, MA 01930
 © 2011 Xylem Inc. 950-0704 12/10 Rev A

RainPerfect™

Solar Powered Rain Barrel Pump System

For more information or customer support
go to rainperfectpump.com



RainPerfect™ is now helping local communities
recycle their rain and conserve water.

Join us at facebook.com/rainperfectpumps to
find out how!