

Shenzhen jimuyida Technology Co., Ltd.

3DMakerpro

Professional Handheld 3D Scanner

Tech Specs

Accuracy		0.1mm (macro core)		0.05mm (micro core)	
Resolution		0.5mm (macro core)		0.2mm (micro core)	
Work Distance		650±250mm (macro core)		300±100mm (micro core)	
Single Capture Range		536×371mm (macro core)		300×200mm (micro core)	
Frame Rate	10fps	Light Source	NIR/LED	Color	24-bit
Dimensions	230×148×188mm	Weight	≤1500g	Output	OBJ/STL/ASC/PLY
Compatible System		Win10/11 MacOS 11/12 (Support M1)			

Compatible Design Software

UnrealEngine	Rhino	Blender	Maya	Meshmixer	MeshLab	TinkerCAD	SketchUp
SolidWorks	ZBrush	Unity3D	3DMax	Cinema4D	Mudbox	Genmagic	Fusion360

🌐 <http://www.3dmakerpro.com/>
🌐 <https://www.jimuyida.com/>
☎ +86 400-080-9959
📞 1494308589
💬 jimuyida1
✉ service@jimuyida.com
📍 21CD, No. 9996 Shennan Avenue, Shenzhen, China 518057



3DMakerpro

Professional Handheld 3D Scanner

Big.
Small.

Whale
All
in
Control.



Shenzhen jimuyida Technology Co., Ltd.



Whale is a professional and super-powerful 3D scanner.

With two cores both in one, Whale is able to scan large-sized objects by activating its macro core; while captures the greatest details of small-sized objects with the micro core at work, achieving an accuracy of up to 0.05mm.

Besides, the advanced NIR optical projection device inside of Whale ensures its easy work outdoors even in strong light.

The intelligent built-in software of Whale is capable of effective restoration of editing on 3D models, which are applicable in various fields such as 3D printing, reverse engineering, prototype design, industrial testing, healthcare, digitalization of cultural relics, education and e-commerce.

Big. Small.
All in Control.



Multispectral Technology

Whale's multi-spectral optical projection device can keep the visible light away and allows easy and accurate scanning even under bright light.

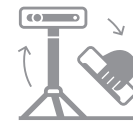

Multi-scan Modes

In the turntable mode, pairing with a tripod and electric turntable, the automatic 3D scanning can generate a 3D model effortlessly within just one click; in the handheld mode, Whale allows you to scan large objects at ease and supports mobile work outdoors when powered by a power bank; turnable plus handheld mode creates endless possibilities for fast model-building and finest details-capturing.

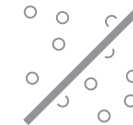

No Markers Required

Featuring high-speed and real time AI visual tracking technique, Whale makes 3D modeling as easy as video taking, leading 3D modeling to even more households. Manual markers are a thing of the past!

AI DOF(depth of field) Calculation

Macro Core ●
fast scan of whole object

Micro Core ●
capture the fine details



Dual-core in One

The macro core is in charge of the fast scanning of the whole object, while the micro core simultaneously captures all the fine details.

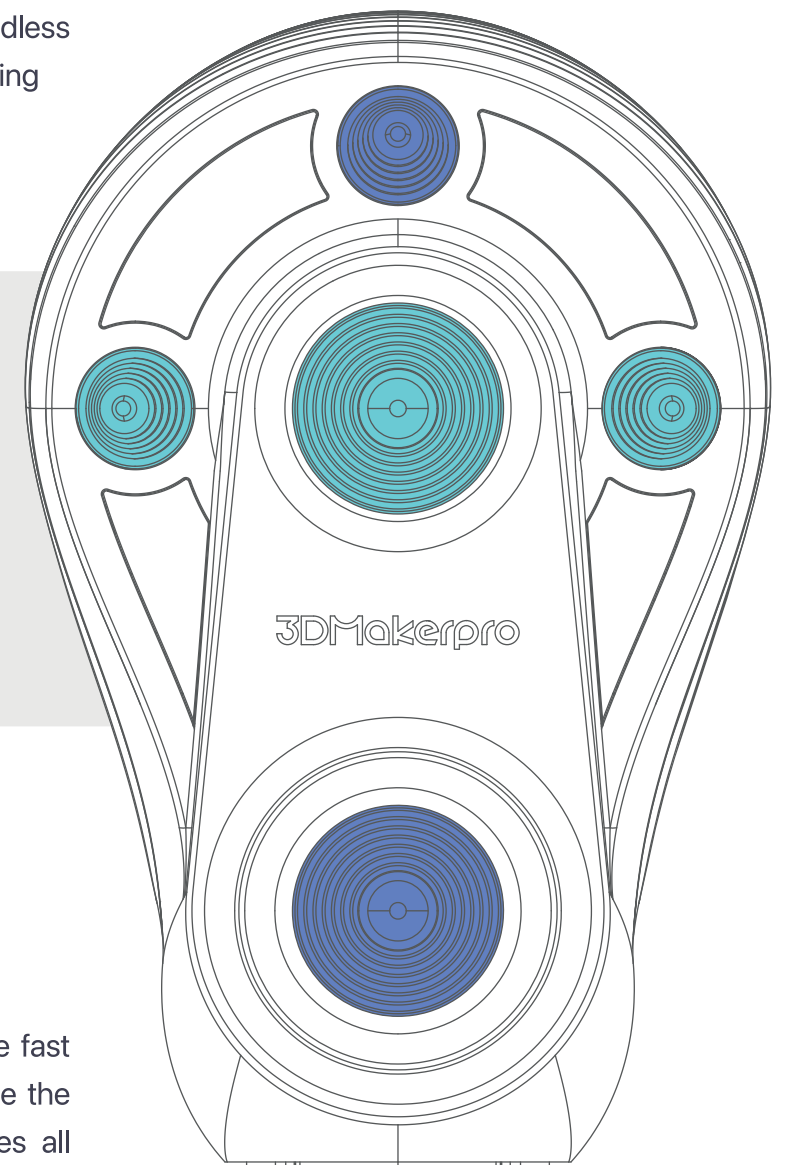



AI-empowered

Through the ensemble algorithms inside, the powerful built-in software is not only compatible with Win10 and MacOS both, but supports automatic alignment of models in different postures, denoising, simplifying, repair and texture mapping.

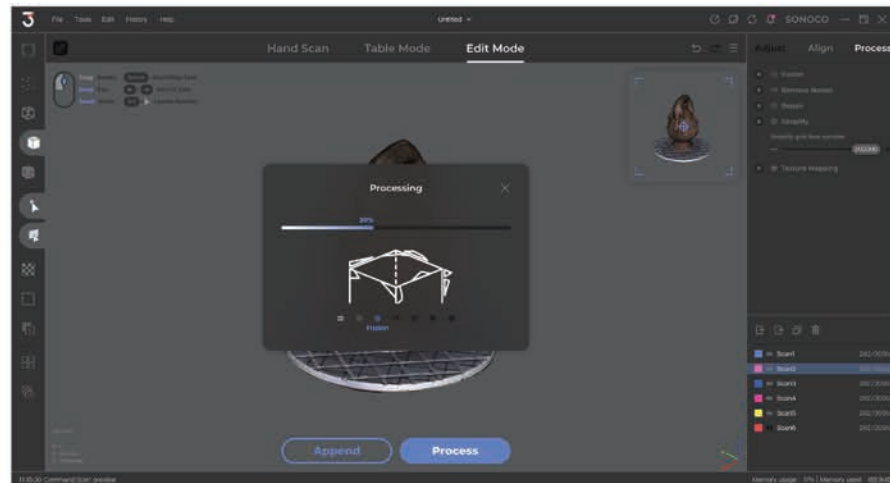

Realistic Color

Whale comes with a professional-level color kit and supports the shooting of complex colors and textures with mainstream DSLR cameras and mirrorless cameras. Whale will automatically map the colors to the models to achieve true color fidelity.



Exquisite Design

The streamlined body, metal casing and modest color embody Whale's professional quality. The physical buttons on the handle save you from struggles with keyboard and mouse; with the built-in software working together, the whole scanning can be done with one single hand.

